

Assembly: Exg. Brick Wall

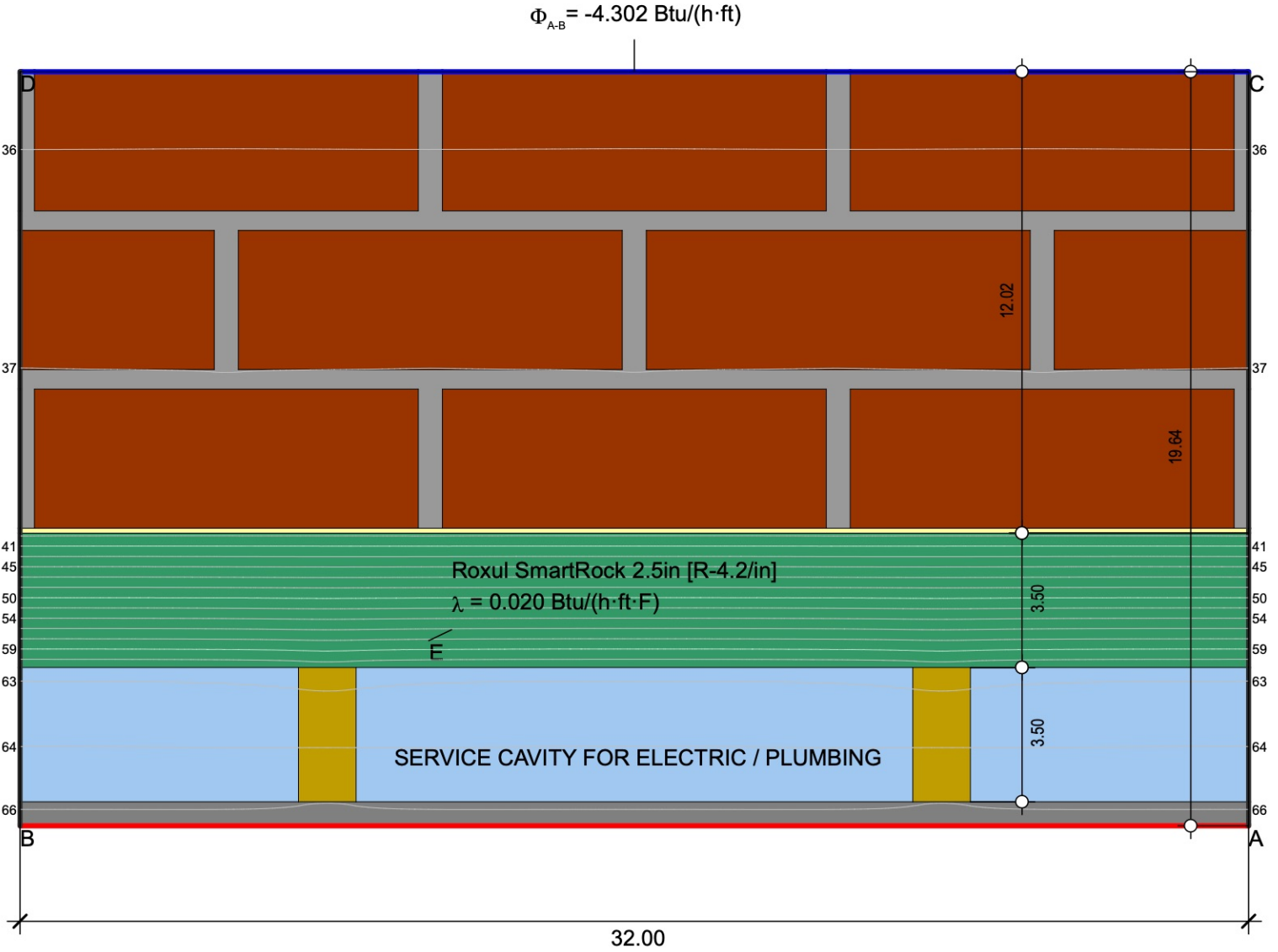

$$U_{eq\ A-B} = \frac{4.302}{33.408 \cdot 2.667} = 0.0483 \text{ Btu}/(\text{h} \cdot \text{ft}^2 \cdot \text{F}) = R-20.7039$$

Boundary Condition	q[Btu/(h·ft <sup>2</sup> )]	θ <sup>o</sup> [F]	h[Btu/(h·ft <sup>2</sup> ·F)]	ε
Exterior, NYC 90d Avg		34.592	4.403	
Interior, normal, horizontal		68.000	1.355	
Symmetry/Model section	0.000			

Material	λ[Btu/(h·ft·F)]
Air layer, unventilated, horizontal, thickness: 40 mm	0.128
Brick (Common) [R-0.2/in]	0.416
GWB (Typ) [R-0.85/in] (1)	0.098
Mortar - Portland Cement-Lime (PHI)	0.520
Roxul SmartRock 2.5in [R-4.2/in]	0.020
Stucco [R-0.2/in]	0.417
Wood, Coniferous (Softwood) [R-1.03/in]	0.081